

MODEL BE 60

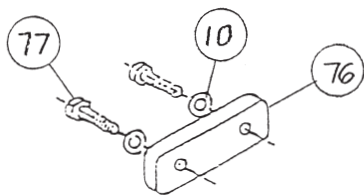

ANODE KIT 1695

## MODEL BE60 HONDA 60 HP 2010

REF	QTY	PART NO.	DESCRIPTION	REF	QTY	PART	DESCRIPTION
1	1	1486	WEDGE BOLT AN	51	1	41	SHAFT BEARING THRUST RING
2	1	553.2	BALL END 1/4X10-32 CABLE	52	2	502	BEARING 7305B-UA
3	1	1485	WEDGE STUD AN	53	1	511	TRUARC 5100-98
4	1	156	BRACKET CABLE SUPT OMC, MORSE	54	1	404	BACKUP WASHER
5	1	543	CLAMP CHRYS 154317	55	1	513	TRUARC N5002-250ZD
6	1	542	SHIM MORSE A035777	56	1	432	UPPER SEAL CARRIER W/SEALS & O RINGS
7	4	561.1	FIL HD SLOTTED 10-24 X 3/4	57	4	517	SPIROLOX RR-150S
8	4	619	NYLOC 10-24	58	2	506	SEAL INNER
9	2	572	BOLT HEX HD 1/4-20 X 5/8	59	2	507	SEAL OUTER 6324-S
10	5	635	1/4 WASHER AN960C416	60	2	527	O RING 568-141 3/32X2 5/16X2 1/2
11	3	616.2	DOWEL PIN 6 X 10 MM	61	1	108.5	BEARING CARRIER W/SEALS & O RING 5/16
12	4	636	WASHER SPRING LOCK M10	62	3	521	O RING 568-011 1/16X5/16X7/16
13	2	592.2	BOLT HEX HD M10-1.25 X 60MM	63	4	602.1	BOLT HEX HD 5/16-18 X 1 PATCH
14	1	592.3	BOLT HEX HD M10-1.25 X 70MM	64	1	106.23	IMPELLER 6 7/8 60 HP
15	1	592.4	BOLT HEX HD M10-1.25 X 90MM	65	1	136	SHAFT SLEEVE PLASTIC LARGE
16	1	1661	SHIFT GUIDE AN, AY-ROD	66	1	1706	IMPELLER TEE KEY - 1/2 ROUND
17	1	573	BOLT HEX HD 1/4-20 X 3/4	67	7	121	SHIM WASHER LARGE
		1980.05	VOLUTE WITH GATE BE	68	1	1781	NUT KEEPER LARGE/PKG 2 PER BAG
18	1	1979.05	VOLUTE WITH EXHAUST TUBE BE	69	1	122.1	SHAFT NUT 3/4-16 BRASS
19	1	128	EXHAUST TUBE ASSY LARGE 2 1/2			1855.05	INTAKE ASSY 6 7/8 FLANGED W/ GRILL & LINER
20	1	847	CLIP EXHAUST TUBE 3/4	70	1	1833	LINER 6 7/8 FLANGED
21	2	621	NYLOC 10-32	71	1	1332.05	INTAKE PAINTED ONLY
22	1	1023	WASHER FIBER 3/8	72	2	14	GRILL ROD
23	1	1022	BOLT HEX HD 3/8-16 X 1/2	73	9	117	GRILL BAR LARGE
24	1	975	LUBE HOSE ASSY	74	6	1319	STUD - INTAKE LARGE
25	1	539	ZIRC FITTING 1/4-28	75	7	625	NYLOC 5/16-18
26	1	550	GREASE GUN	76	1	1635	ANODE PAD - SMALL, MED, LRG
27	1	552	GREASE 10 OZ TUBE NO. 630AA	77	2	587.3	BOLT HEX HD M6-1.0 X 25MM
28	1	1172.05	REVERSE GATE LARGE	79	4	640	WASHER SPRING LOCK 5/16
29	2	536	NYLINER 1/2 ID X 13/16	81	1	1719	TORSIONAL DAMPER 3/4
30	1	1178	SPRING GATE PIVOT 1/2				
31	2	823	PIN GATE PIVOT 1/2 LARGE				
32	1	1043	SHAFT ROLLER				
33	3	624	NYLOC 1/4-28				
34	1	1042	ROLLER ASSY.				
35	2	623	NYLOC 1/4-20				
36	1	1034	SHIFT CAM LARGE				
37	2	2058	EXHAUST BAFFLE BE60				
38	1	467	COLLAR BACKFIT 7305				
39	2	637	WASHER SPRING LOCK #10				
40	1	1534	SPACER 7305				
41	1	1037	BUSHING CAM				
42	1	1038	WASHER CAM				
43	2	1039	SHIM - CAM				
44	1	1036	CAM ECCENTRIC DRILLED				
45	1	574.1	BOLT HEX HD 1/4-20 X 1 PATCH				
46	2	574	BOLT HEX HD 1/4-20 X 3/4 PATCH				
47	1	1170	SPRING GATE BUMPER				
48	1	1497	GATE BUMPER				
49	1	559.2	FIL HD SLOTTED 10-32 X 1 1/4 PATCH				
50	1	2060	SHAFT ONLY, BE60 19T 29 15/16 LG				
	1	2061.1	SHAFT ASSY COMPLETE BE60 19T				

SIZE	TORQUE
1/4-20 (M6)	8-9 FT-LBS
5/16-18 (M8)	12 FT-LBS
3/8-16 (M10)	22 FT-LBS

TILLER STEERING  
SHIFT CABLE ASSY 2064 SEE PAGE 25.6

BEARING, SEAL, SNAP & "O" RING KIT  
1 BRG 462.1